

Opening Hours:

Mon - Sat: 10am - 5pm

Sun: 12.30 - 4.30pm

**Last entry is 15 minutes
before gallery closing time.**

Admission: Free

www.themcmanus-dundee.gov.uk

Designed by Marketing & Design
Leisure & Communities, Dundee City Council.



Museum Guide

the mcmanus
DUNDEE'S ART GALLERY & MUSEUM

Welcome

Welcome to The McManus, Dundee's best loved building.

Nearly 150 years old, but looking as good as new, this building, the largest monument to Prince Albert outside London, has been given a complete makeover.

Displays spanning 400 million years recount the City's fascinating history. Nowhere else could you find the famous Tay Whale, the world's oldest Astrolabe and a Rossetti masterpiece all under one roof.

Art, history and nature are brought to life with film, sound and interactives to create a unique experience for all the family.

We hope you enjoy your visit!

Access

The McManus is committed to increasing access for all.

Four disabled parking bays are located to the north of the building. There is level access to both north (rear) and south (main) entrances to the building. There is full wheelchair access to all public areas of the building and a lift to all floors. Wheelchairs are available for loan from the reception area which is also fitted with an induction loop.

Room thresholds have lighting to assist visitors with partial sight and there are larger text sizes and colour coding on displays. Guide dogs, hearing dogs and other recognised assistance dogs are admitted.

Accessible toilets are available in the Gothic Hall. A further accessible toilet is available in the Creative Learning Studio for participants in Learning programmes.

There is free Wi-Fi available throughout the building.



The Long Gallery

In Human Memory
Mike De Haan



The Victoria Gallery

Dante's Dream
Dante Gabriel Rossetti



Dundee and the World

Dance Headdress
Ekoi People, Nigeria



20th Century

Consider The Lilies
Peter Collins



Landscapes and Lives

Mammoth Tooth
Ice Age



The Making of Modern Dundee

The Tay Whale

Floor 1

Dundee and the World

Explore the City’s international collections, evidence of Dundee’s long involvement in international trade. Discover what these objects tell us about the particular cultures they originated from and how they came to be here.

The displays are housed in the stunning Albert Hall, with its magnificent wooden ceiling and spectacular stained glass.

The Victoria Gallery

Experience an authentic Victorian Art Gallery. The restored curved red walls, vaulted glass ceiling, ornamental plasterwork and varnished dadoes create an impressive setting for densely hung historic oil paintings dating from 1750-1914.

20th Century Gallery

Consider the Lilies: Scottish Painting 1910-1980. This acclaimed exhibition, a partnership project with the National Galleries of Scotland, returns to Dundee after a successful tour. It features work by the Scottish Colourists, John Houston, Alberto Morrocco and James McIntosh Patrick.

The Long Gallery

Reactions - showcases our studio ceramics and explores the processes that have created the stunning pieces on display.

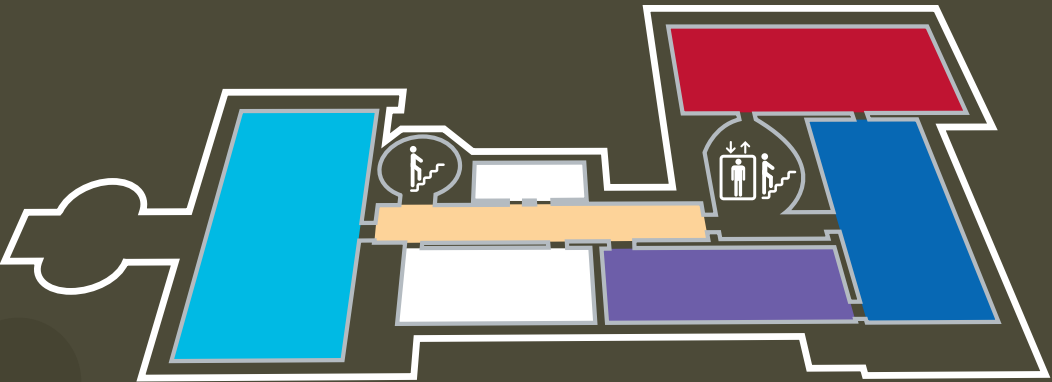

Here and Now

This gallery introduces our most recent fine art acquisitions all purchased through the National Collecting Scheme for Scotland. The display reflects the diversity of contemporary art practice.

Creative Learning Suite

Our Creative Learning Suite comprises of two spaces - the Studio and the Study. As the main Creative Learning space, the Studio is dedicated to ‘hands-on’ creative activity, including artist-led workshops, projects and events. The smaller Study space houses a unique range of learning resources, offers IT access and hosts a programme of talks and seminars.

Floor 0

Reception/Cafe/Shop

New reception area with external terrace accommodates our cafe and shop.

The History of the Museum

Follow the story of the creation of this building and its changing uses over the years.

What is a Museum?

How and why do museums do what they do? Find out how we care for and share the rich material in our collections.

Landscapes and Lives

Journey 400 million years into the past and witness the creation of Dundee’s natural landscape. See the animals that used to live in our area. Explore the lives of early people and see how a small settlement developed into the Burgh of Dundee.

The Making of Modern Dundee

Experience the influences that shaped the City from the 1850s right up to the present day. From shopping to work, through two world wars, this gallery explores the development and successes of the City and its people.

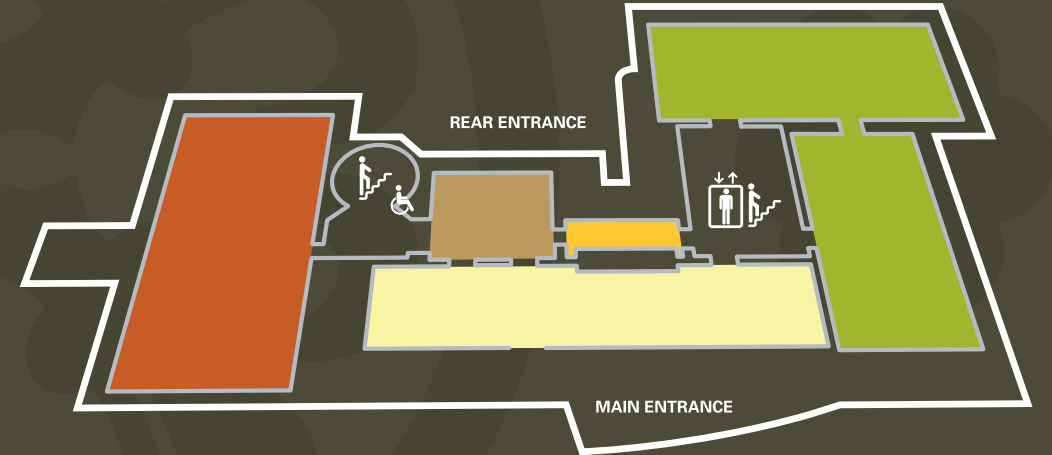

Floor -1

Toilets are located on Floor -1. Use the lift or the stairs from the new central circulation core.

Also during your visit, look out for:

David Batchelor’s newly commissioned lightwork ‘Waldella, Dundee’ (right), which hangs through three floors of the central circulation core.

Cleaned and restored stained glass on: the Victorian Grand Stair; in the cafe; Dundee and the World; Landscape and Lives.

Views of the statuary of The McManus steeple from The Long Gallery.

Views of the building’s turreted rooftop from Floor 2.



Image: rossfrasermclean

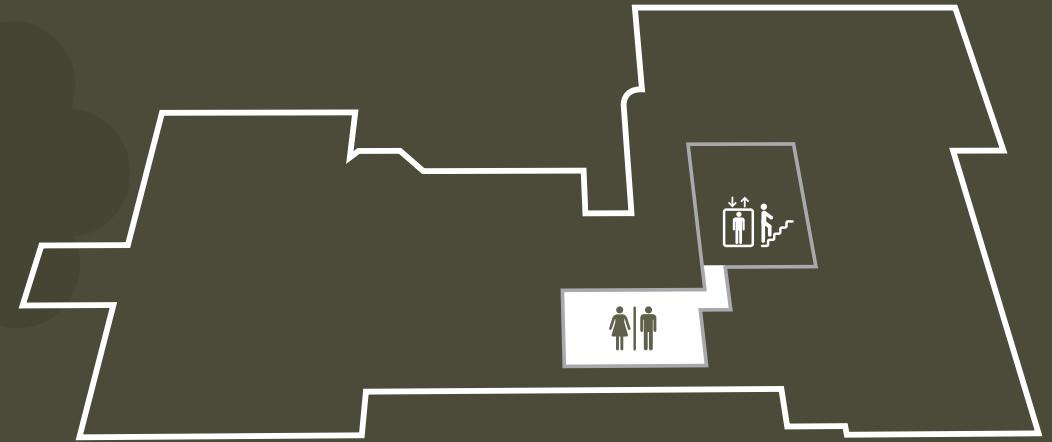

Key to Symbols



RECOGNISED



Female Toilets



Male Toilets



Lift



Stairs

The City’s fine art, decorative art and whaling collections are recognised as being of national significance.